

Ostomy bag 2-piece open

Ostomy baseplate

Ostomy Care



Instructions for use

23325573 Version 1 The Coloplast logo is a registered trademark of Coloplast A/S. All rights reserved.© 2021-01-19

Intended purpose

The ostomy bag is intended to passively collect output from a stoma. The adhesive baseplate is attached to the ostomy bag and is intended to adhere to intact skin around the stoma.

Indications

The device is indicated for people with a stoma.

Warnings

Re-use of the single use product is not recommended as cross contamination may occur.

Reprocessing, washing, disinfection and/or (re)sterilisation may compromise product characteristics, causing additional risk of physical harm or infection to the user.

Cautions

For appropriate use, consult your health care professional before you start using a convex product.

The ostomy bag is labelled as MR unsafe due to the presence of the clip for closure containing metal. The bag or the metal clip should be removed before MR scan.

This non-sterile product contains raw materials of natural origin, and there is a risk that the materials carry pathogens which cannot be fully removed by even the most stringent manufacturing processes. Therefore, the product carries an increased risk of infection for vulnerable patient groups and should be used with caution for babies and infants with immature immune systems and infants receiving immune suppressive treatment.

Information

Single use ostomy bag.

The products are intended to be stored in the box until removed for use, as the box protects the products and the label on the box contains important information like batch code, use-by date and a unique barcode.

Special storage conditions

Keep away from sunlight.

Store baseplate horizontally.

How to use

Preparation

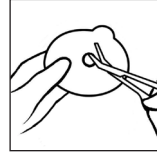

Cut a hole in the baseplate to fit the exact size and shape of the stoma using a pair of small curved scissors and the cutting guide on the baseplate. You can use the enclosed stoma measuring guide to measure the size and shape of the stoma. An exact fit between the hole and the stoma is important to reduce the risk of leakage and skin problems.

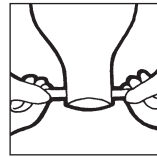

Remove a clip from the sheet and remove the protective paper. Place the adhesive side down at the opening. If the clip is not placed correctly the first time, remove and reposition it. Fold up to 4-5 times working towards the skin and then fold back the ends of the clip. With a hard clamp it is only necessary to fold the bag once before closing the clamp.

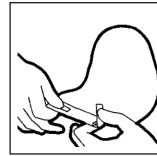

Thoroughly clean the stoma and the surrounding skin area. The skin must be completely dry before application of the baseplate.

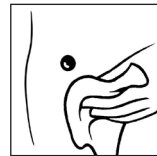

Application



Peel off the protective film from the adhesive.



Align the baseplate around the stoma and apply pressure to the baseplate to ensure fast adhesion and a perfect fit between the adhesive and the skin around the stoma. The adhesive must fit snugly around the stoma. To prevent leakage it is important to ensure a tight seal around the stoma. When applying pressure to the baseplate/bag on the abdomen, begin in the area around the stoma and press the adhesive to the skin. Run a finger all the way around the stoma to ensure that the adhesive seals. Smooth the adhesive down, starting from the stoma and moving outwards to the edges, to ensure that the adhesive has made full contact with the skin.

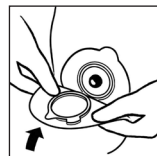

Ensure the baseplate is dry and clean (when cleaning the baseplate only use water). Make sure that the lock ring is open. Position the bottom of the bag coupling at the bottom of the baseplate coupling.

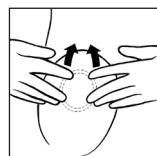

Press the bag and the baseplate together at the bottom with your middle fingers.



Close the lock ring by pressing the lock together. The bag is securely attached to the baseplate when you hear a 'click'.

How to empty the bag

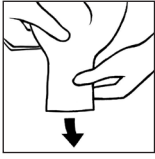

Open the outlet and empty the bag into the toilet when needed.



Clean the outlet, for example with toilet paper. Fold and resecure the outlet after you have emptied the bag.

Removal



Remove the bag by opening the lock ring by pressing the small tab with a finger tip.



Hold on to the removal ear and remove the bag by carefully pulling the bag away from the baseplate.

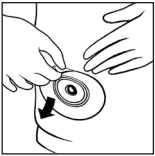

Gently remove the baseplate by pulling the removal ear on the baseplate away from the stomach and roll the baseplate slowly downwards. Apply light pressure on your skin with your free hand to help removal.

Disposal

The product is intended for single use only and should be disposed of in accordance with local guidelines, e.g. with normal household waste.

Do not flush the product down the toilet.

Filter label



If required, to prevent gas from escaping, place one of the enclosed filter labels on the filter.

Reporting of incidents

If, during the use of this device or as a result of its use, a serious incident has occurred, please report it to the manufacturer and to your national authority.

Explanation of symbols



Medical device



Indicates that the product is in compliance with European legislation for medical devices



Catalogue number



Use-by date (YYYY-MM-DD)



Batch code



Date of manufacture (YYYY-MM-DD)



Manufacturer



Consult instructions for use



Do not re-use



Indicates a barcode as containing Unique Device Identification



Global Trade Item Number



Keep away from sunlight



This way up



Recyclable packaging



MR Unsafe