



Instructions for use
23322117 Version 2

The Coloplast logo is a registered trademark of Coloplast A/S. All rights reserved. © 2019-04-24

Distributed by
Coloplast Corp
1601 West River Road North
Minneapolis, MN 55411 USA
www.coloplast.us
Tel. 1-800-533-0464

Please read all instructions before using this device.
Caution: Federal law restricts this device to sale by or on the order of a licensed health care practitioner.

Indications

The catheter is indicated for use by patients with urine retention and patients with a post void residual volume (PVR) due to neurogenic and non-neurogenic voiding dysfunction. The catheter is inserted into the urethra to reach the bladder allowing the urine to drain.

The product is for male patients only.

Information

Coloplast accepts no liability for any injury or loss that may arise if this product is used in a manner contrary to Coloplast's current recommendations.

The solution in which the catheter is stored is harmless.

Catheterization should take place as quickly as possible after opening the package. The catheter should always be removed when the bladder has been emptied.

Cautions

Do not use if package is damaged

Keep away from sunlight.

Contact your healthcare professional before you perform self-catheterization for the first time.

Contact your healthcare professional if you:
- experience symptoms such as fever, discomfort when emptying the bladder, a frequent urge to urinate or blood in the urine.

Contraindications:

The device is contraindicated in the presence of conditions which create unacceptable risk during catheterization.

Warnings

Re-use of the single use product may create a potential harm to the user. Reprocessing, washing, disinfection and/or sterilization may compromise product characteristics, causing additional risk of physical harm or infection to the user.

How to use

Preparation

Please wash your hands. Wash the area around the urethral opening with soap and water in a circular motion starting from the urethra (urinary passage) to the outer edges of the penis. This should be done only once.

Make sure you are completely ready to proceed with catheterization before you open the packaging. Complete the catheterization without undue delay and remove the catheter upon emptying the bladder.

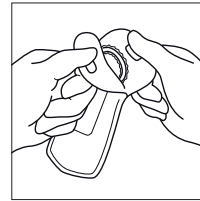

Opening method 1:
Peel open the packaging. Take out the catheter.

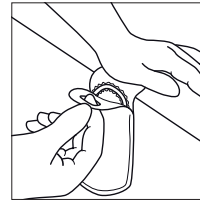

Opening method 2:
Stick the packaging to a horizontal surface using the upper part of the adhesive label on the backside. Peel open the packaging. Take out the catheter.

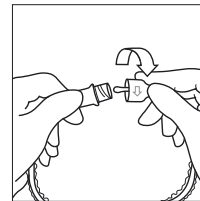

Twist to open the catheter.

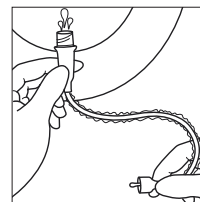

Drain the water through the drainage end in the toilet or sink before catheterization.

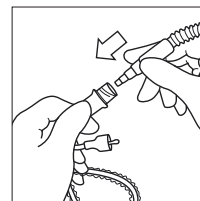

Alternatively, a urine bag can be attached to the connector end and the water will empty directly into the urine bag.

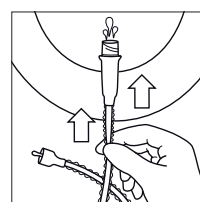

Slide your fingers down the sleeve to drain the last drops of water.

Insertion

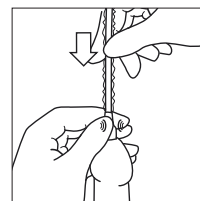

While supporting your penis, guide the tip of the catheter into the opening of the urinary passage.

Once the tip is lodged in the urinary passage, make sure you hold your penis and the turquoise handle in the same hand.

With your other hand, start pulling the sleeve to insert the catheter towards the bladder.

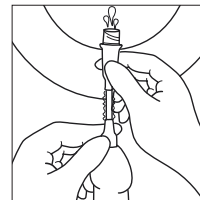

Once urine starts to flow stop inserting the catheter.

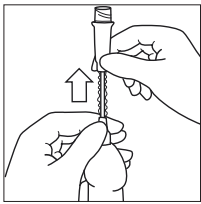

When urine stops flowing, pull the catheter out about 1-2 cm. If urine starts flowing again, wait until it stops. Then pull the catheter out 1-2 cm again. When your bladder is empty, remove the catheter.

Disposal

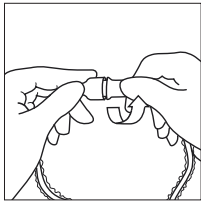

After use, the catheter can be re-closed by rejoining the two turquoise handles together.

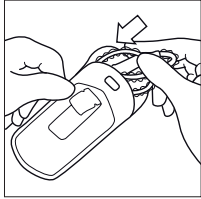

Return the catheter to the packaging.

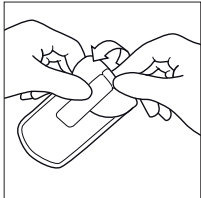

Use the sticker on the backside to re-close the packaging.

The product is intended for single use only and should be disposed of in accordance with local guidelines, e.g. with normal household waste.

Do not flush the product down the toilet.

Symbols



Not made with natural rubber latex



Manufacturer



Use-by date



Batch code



Consult instructions for use



Do not re-use



Date of manufacture



Sterilized using irradiation (R)



Do not use if package is damaged



Keep away from sunlight

Rx ONLY

Prescription use only

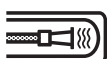

Pre-lubricated, ready-to-use intermittent urinary catheter